

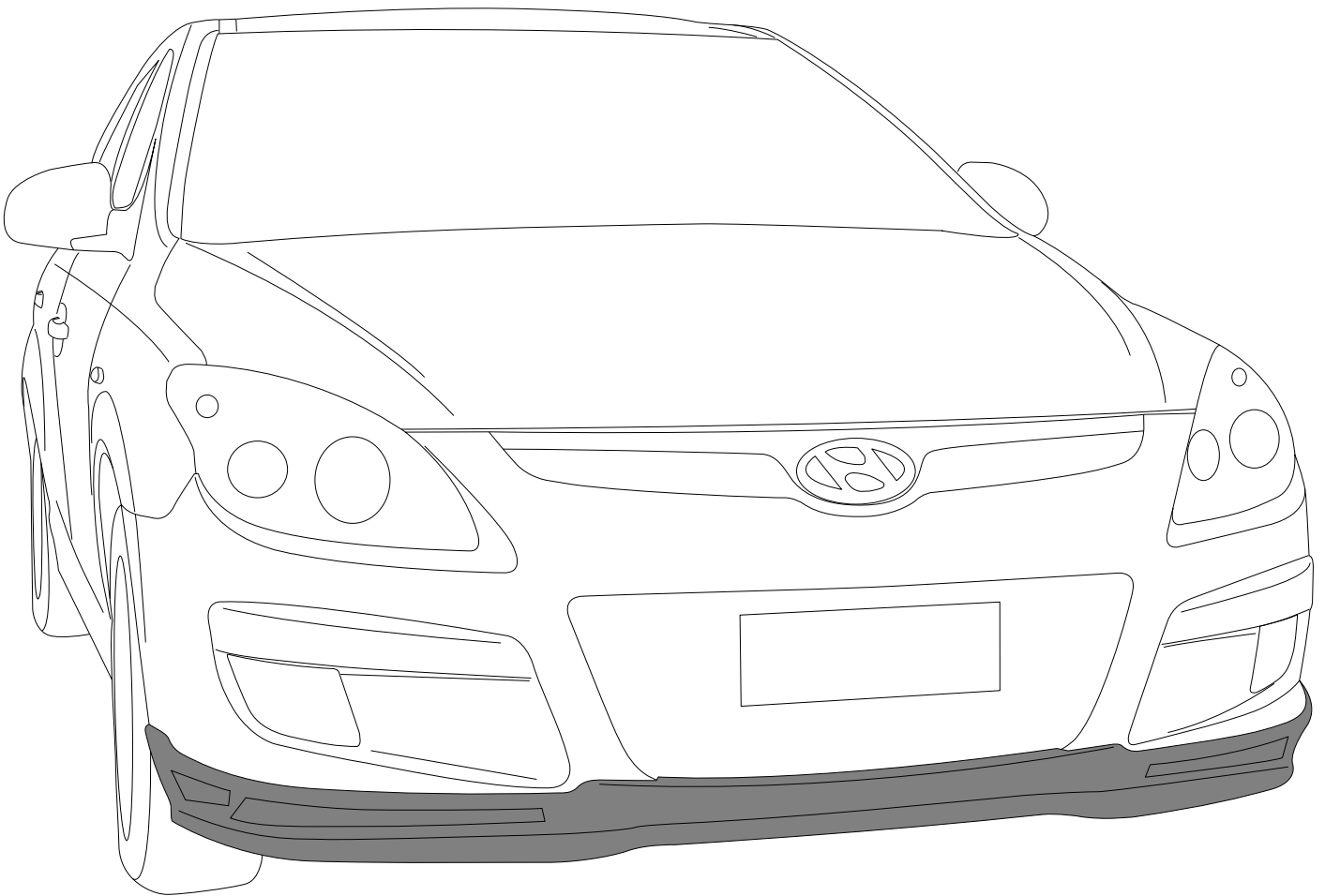

Genuine  
**HYUNDAI**  
Accessories

**FITTING INSTRUCTIONS FOR  
HYUNDAI - i30 HATCH  
FRONT SKIRT  
FITTING TIME: EST 45 MINUTES**



**ISSUE: 3  
ISSUE RELEASE DATE: 10/02/2009  
TOTAL NUMBER OF PAGES INCLUDING COVERSHEET: 6**

## 1. TOOLS AND MATERIALS REQUIRED

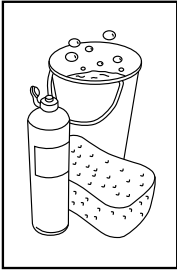
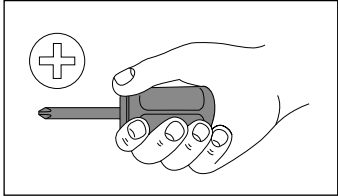
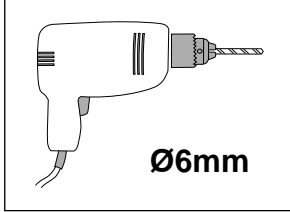
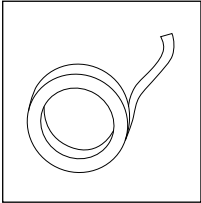
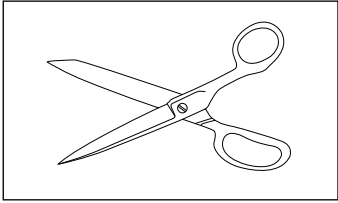
 <p><b>CLEANING MATERIALS</b></p>	 <p><b>No. 2 PHILLIPS SCREWDRIVER</b></p>	 <p><b>Ø6mm DRILL BIT &amp; DRILL</b></p>
 <p><b>MASKING TAPE</b></p>	 <p><b>SCISSORS</b></p>	

### COMMENTS:

**Place these instructions in vehicle's glove box after installation is complete**

#### Care Instructions:



Clean Front Skirt with a mild detergent and water solution.



Do not use abrasive cleaners or solvents.

### IMPORTANT

- For unpainted product - Front Skirt must be painted and cured sufficiently prior to installation onto the vehicle.
- This product must be installed exactly as specified in these instructions. Failure to do so may result in improper fit and/or retention.
- Installation to be completed by 2 people.
- Do not drive the vehicle within 6 hours (Minimum) of installing.
- Avoid installing at temperature less than 10° C (50° F). Ideal installation temperature is between 20° C - 40° C (69° F - 105° F). If installing at temperatures less than 10° C (50° F) do not drive vehicle for at least 12 hours.
- The use of automatic car washers is not recommended, as damage to Front Skirt may occur.

## 2. KIT DRAWING AND CONTENTS

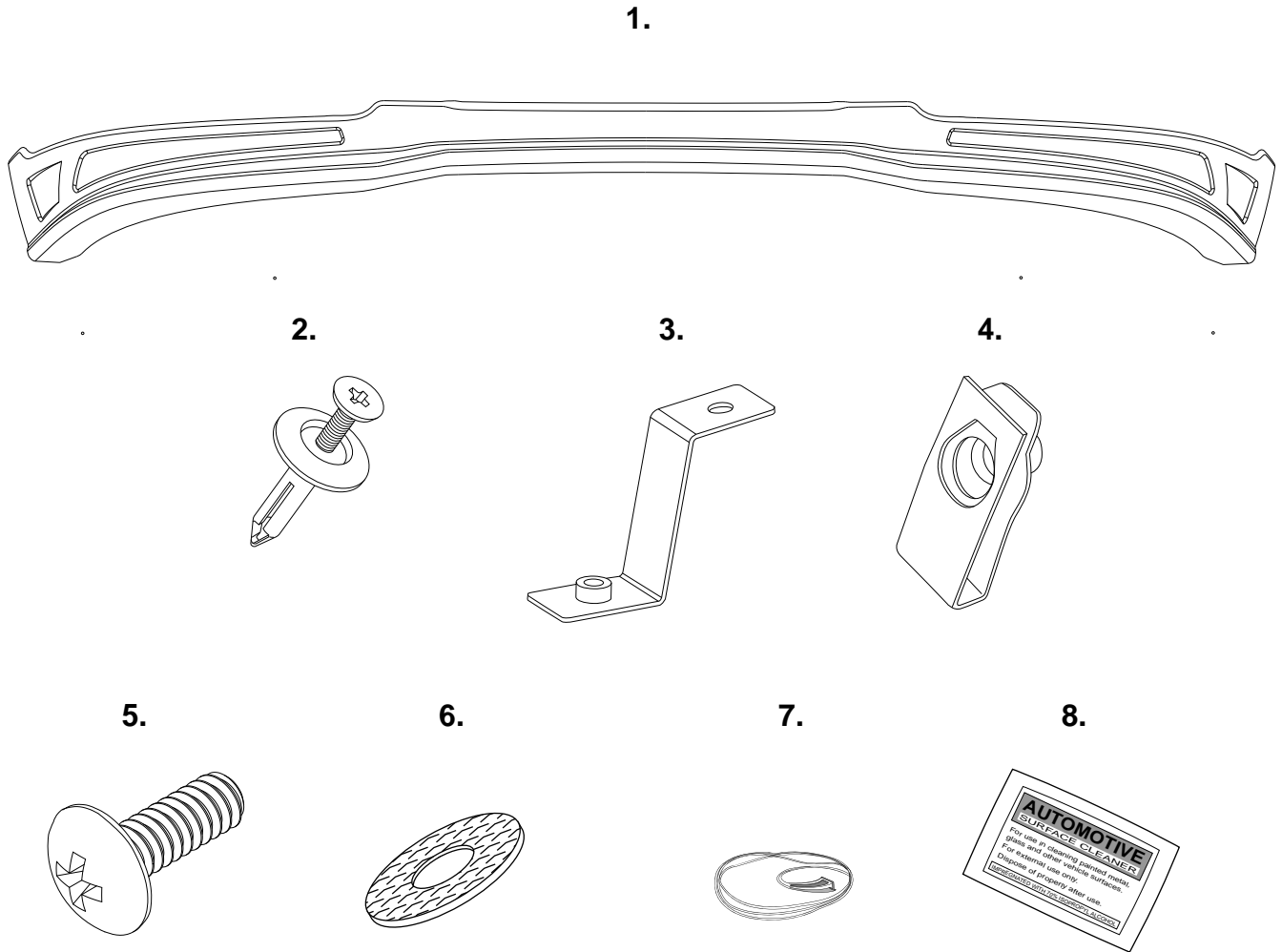

ITEM NO.	PART NUMBER	QTY	DESCRIPTION
1	P05159	1	Front Skirt
2	FAST0086	2	Scrivet
3	CLIP1324	4	Bracket Mount
4	NUTS0155	4	M5 'U' Nut
5	SCRW0374	8	M5 x 16mm Phillips Head Screw
6	WASH0099	8	M5 Fibre Washer
7	MISC1779	1	Trim Edge Extrusion
8	MISC0052	2	Alcohol Wipe

### 3. INSTALLATION STEPS

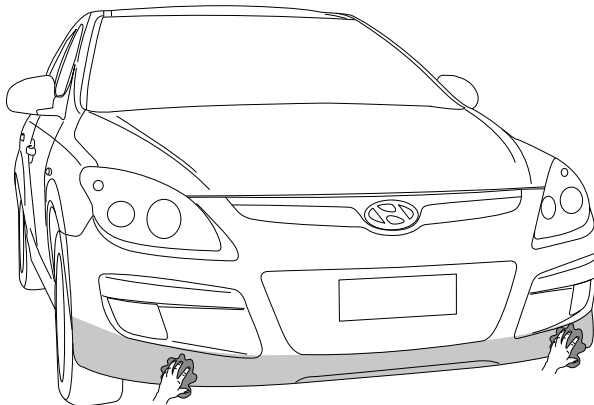
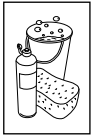

**1.**  
Thoroughly clean and dry the installation areas, ensuring insides of wheel arches and under the front bumper are free from dirt, grease and wax.

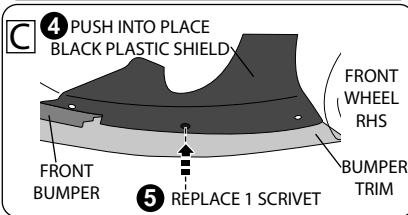
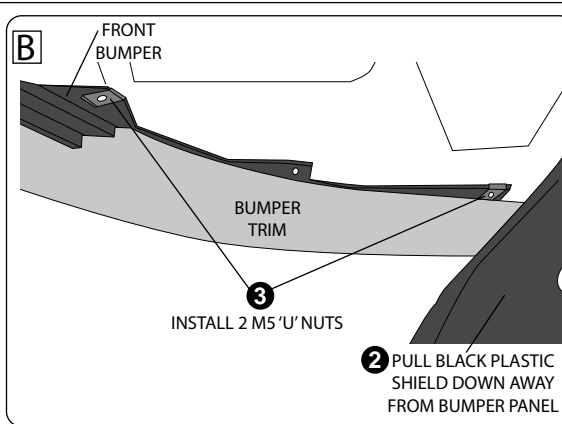
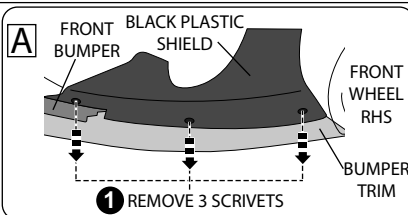

**2.**  
Remove six (6) scrivets (3 per side) and discard four (4) from under the front bumper as shown. Pull black plastic shield down away from the bumper panel. Install two (2) M5 'U' nuts per side (4 total) onto the bumper in locations detailed. Push black plastic shield back into place and fit two (2) scrivets (1 per side) back into the middle hole with no M5 'U' nut fitted as shown.

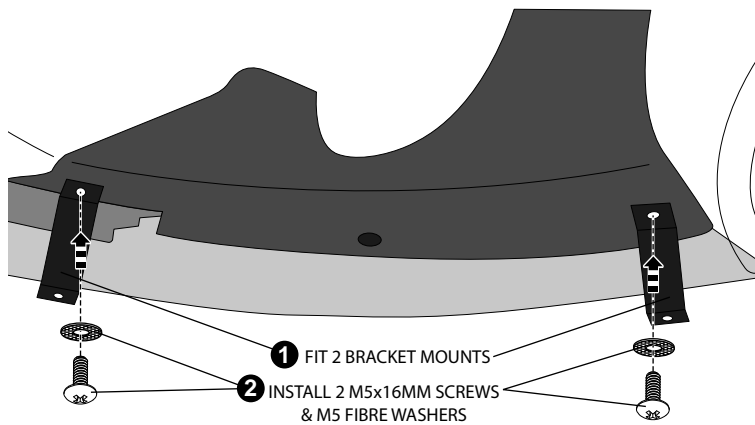

**3.**  
Install four (4) bracket mounts (2 per side) to the front bumper using four (4) M5x16mm screws and M5 fibre washers (2 per side) into the previously fitted M5 'U' nuts. **Do Not fully tighten at this stage.**

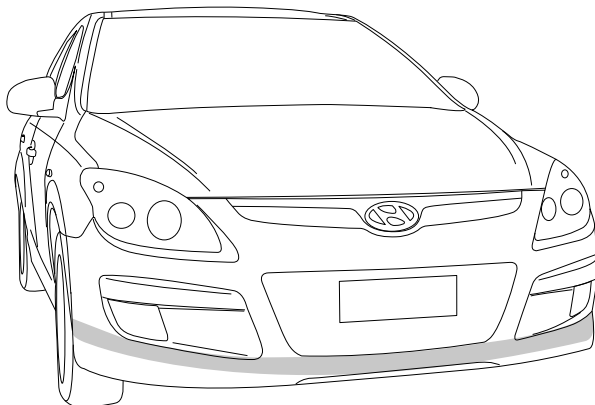

**4.**  
Clean the shaded areas using the alcohol wipes provided and wipe away residue with a dry clean cloth.

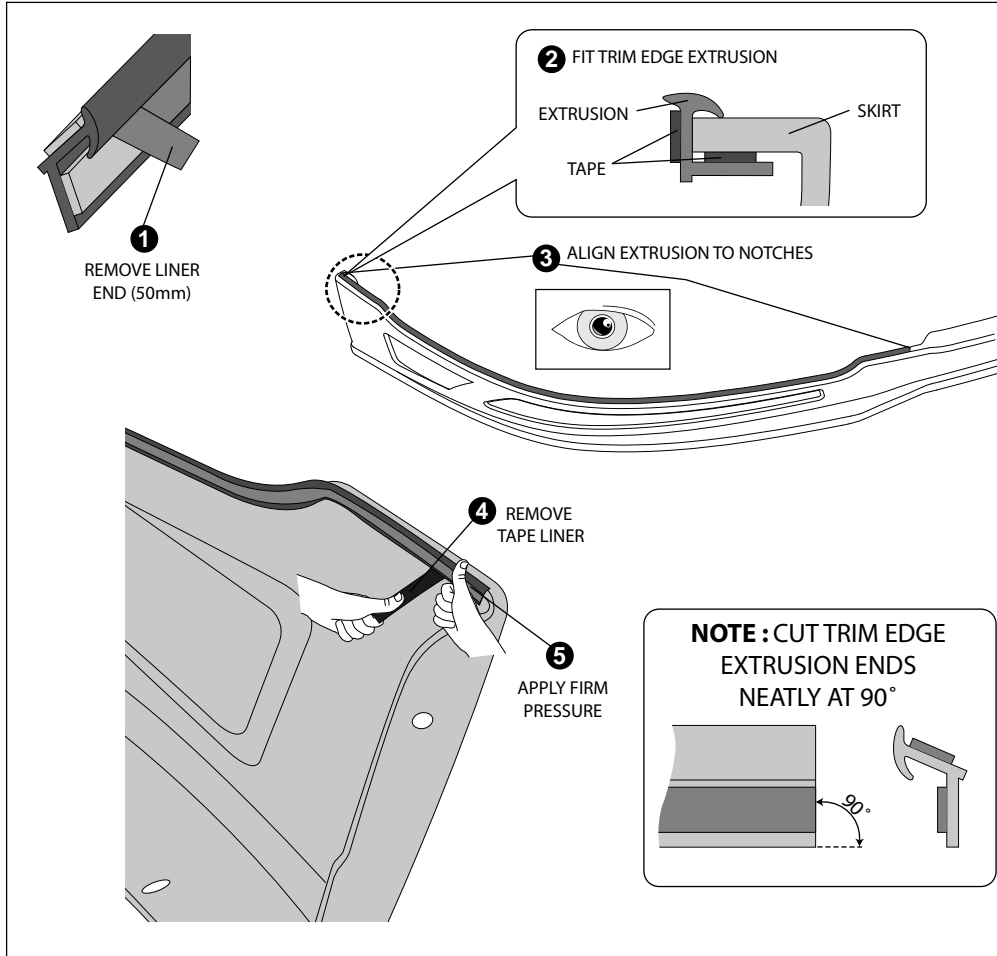

**5.** Cut trim edge extrusion in half. Remove approximately 50mm of the internal protective liner from the trim edge extrusion as shown, and fit to the front skirt. Cut trim edge extrusion to length for a neat fit. **Note: Take care in cutting the ends of the trim edge extrusion to 90°, as this will effect the final appearance on the vehicle.** Ensure extrusion is aligned with the notches on the part. Pulling at right angles to the extrusion, remove the liner from the extrusion in small portions and apply thumb pressure to ensure that it adheres to the Front Skirt as the extrusion is installed. Repeat process for the other side of the front skirt.

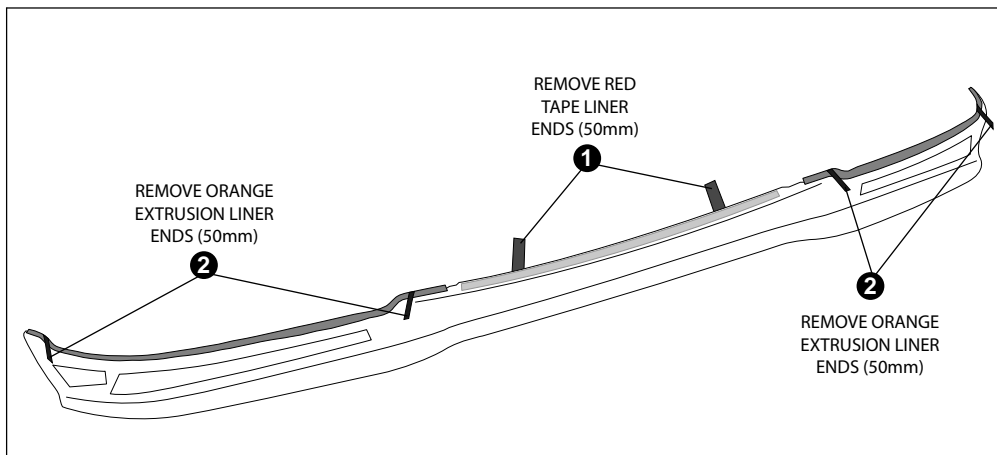

**6.** Peel 50mm from each end of the protective liner from the double sided tape located on the underside of the top centre flange on front skirt and trim edge extrusion. Ensure these tape liners are accessible when the front skirt is fitted to the vehicle. Use masking tape to hold if required.

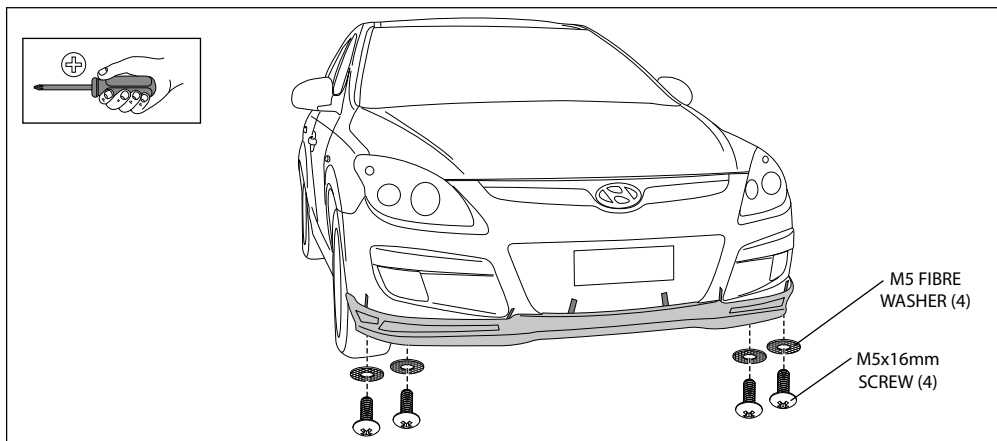

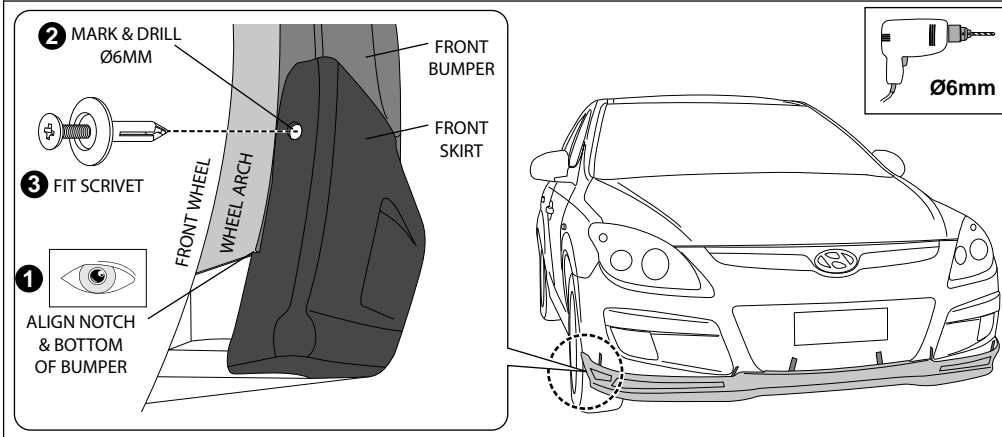

**8.** Check the position of the front skirt at the wheel arches. Align notch on front skirt to the underside of the front bumper. Turn vehicle wheel for access and drill Ø6mm hole into the bumper and repeat for other side of the vehicle. Fit two (2) scrivets (1 per side) to the front skirt as shown.

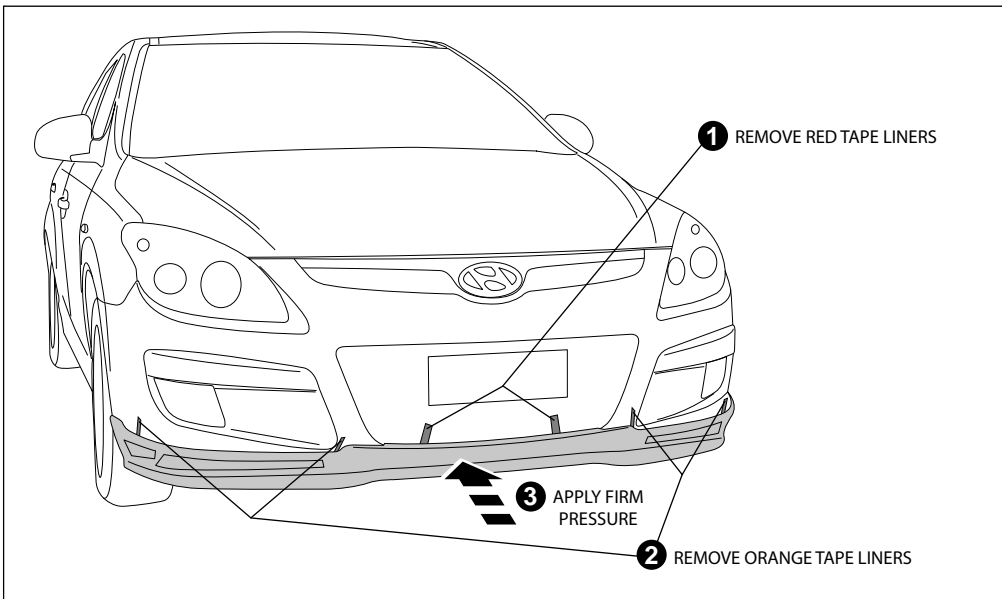

**9.** Finally remove red and orange tape liners carefully to ensure they do not break, and apply firm pressure along taped area to ensure maximum adhesion.